

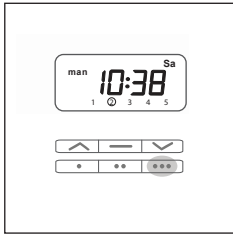

Additional
Function

Effective channel selection



Press "channel increasing button" or "channel decreasing button" to switch required channel.

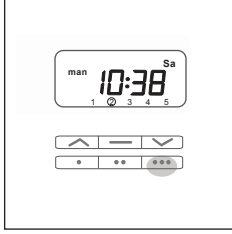

Long press"channel increasing button" repeatedly for 5 seconds, the channel is ineffective if the channel lamp displays.

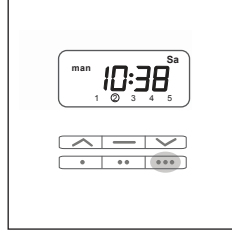

Long press"channel increasing button" repeatedly for 5 seconds, the channel is ineffective if the channel lamp displays.



Long press"channel increasing button" repeatedly for 5 seconds in order to check if the channel switching is effective or not.



Additional
Function

Mode Switch

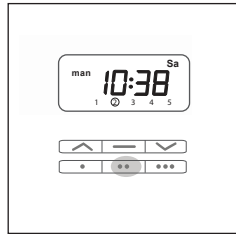

Long press"setting button" for 2 seconds, switch to manual mode

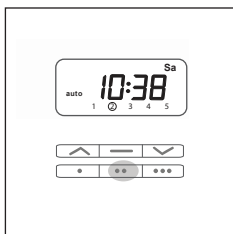

Long press"setting button" for 2 seconds, switch to auto mode

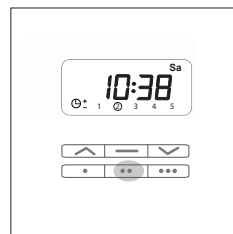

Long press"setting button" for 2 seconds, switch to random mode



Long press "setting button" for 2 seconds, switching the modes circularly



The Current Time Setting



The manual mode under any channel can adjust the current time

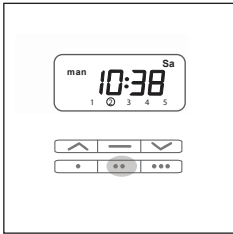

Long press"setting button" for 2 seconds, switch to manual mode

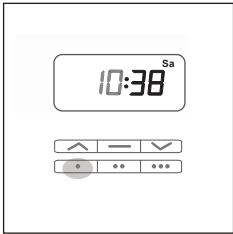

Long press"channel decreasing button" for 5 seconds, "hour mark" twinkles.

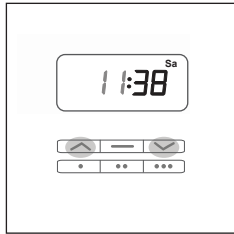

Press "up button" or "down button", can adjust hour.

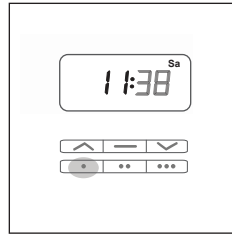

Press"channel decreasing button" until the "minute mark" twinkles.

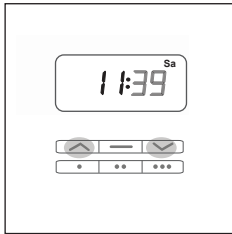

Press "up button" or "down button", can adjust minute.

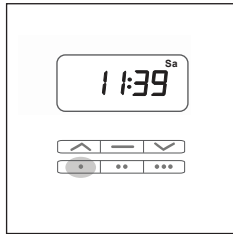

Press"channel decreasing button" until the "week mark" twinkles.

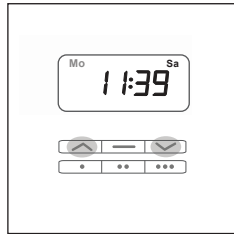

Press "up button" or "down button", can adjust week.

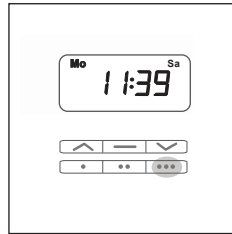

Press "channel increasing button" to confirm the current time.



Self-lock function



Simultaneously press "channel decreasing button" and "channel increasing button" repeatedly for 3 seconds, self-lock function exit.

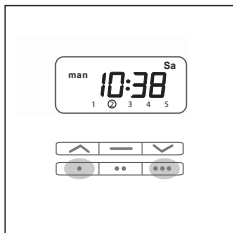

Simultaneously press "channel decreasing button" and "channel increasing button" for 3 seconds

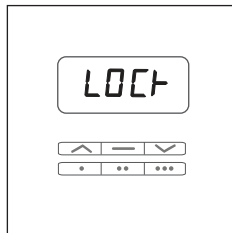

the display screen will show "lock", the self-lock function starts and the button is



Control System

DC661 time emitter

Specification



Version No.: A/00



Technical Support

- Input voltage: 3V(CR2430)
- Transmitting frequency: 433.92MHz
- Transmitting power: 10 milliwatt
- Operating temperature: $-20^{\circ}\text{C} \sim +55^{\circ}\text{C}$
- Transmission distance: 200 meters open office
35 meters on two walls

- Up button: Control motor upward and Time increase
- Down button: Control motor downward and Time decrease
- Stop button: Control motor stop and Exit time set
- Channel decreasing button: Control the decrease of channel and the limit of time
- Channel increase button: Control the increase of channel, time confirmation and check the time effectiveness of channel switching
- Setting button: Setting button(effective for Radio motors) and mode adjustment

DC447 DC448 is 5-channel time emitter. A number selected in the LCD screen means an emitting channel selected.

Press "channel decreasing button" and "channel increasing button" to switch the channels until the required number selected, then stop pressing, and the present channel is the channel select For example, 1,2,3,4,5, channel 2 is the present channel.

1 When 1,2,3,4,5 numbers are all selected, "group control" channel is the present channel, do as follows:

The manual mode of "Group control" (12345)—The group control button controls the movements of all motors, the timing function of group control is ineffective.

The auto mode of "Group control" (12345)—The group control button controls the movements of all motors. When the channels selected is ineffective, the timing function of the channel is ineffective. When the channels selected is effective, the timing function of the channel is effective. The timing time will function on time.

The auto mode of "Group control" (12345)—The group control button controls the movements of all motors. If the channel is not selected, the timing function is not available; if the channel selected, the timing function is available. The timing time will function more or less than 15 minutes.

2 When one of 1,2,3,4,5 numbers is selected, this number is the present channel, do as follows:

The manual mode of this selected channel—Press the button to control the movements of motors, the timing function is ineffective.

The auto mode of this selected channel—Press the button to control the movements of motors. When the channels selected is ineffective, the timing function of the channel is ineffective.

When the channels selected is effective, the timing function of the channel is effective. The timing time will function on time.

The random mode of this selected channel—Press the button to control the movements of motors. When the channels selected is ineffective, the timing function of the channel is ineffective. When the channels selected is effective, the timing function of the channel is effective. The timing time will function more or less than 15 minutes.

Note1: The time difference between setting up limit time and down limit cannot be less than 32 minutes. Otherwise the Error will show on the LCD screen of transmitter under Automatic mode and Random mode. Simultaneously, Time set is invalid, and set status is exited.

Note 2 : There is no timing setting when under group control channels status



Technical Support

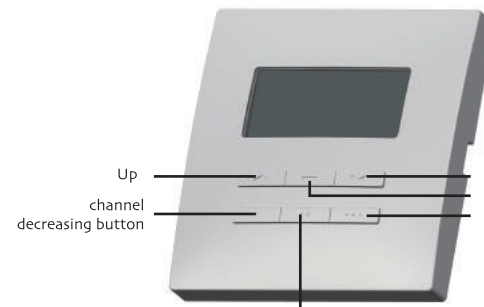

DC661

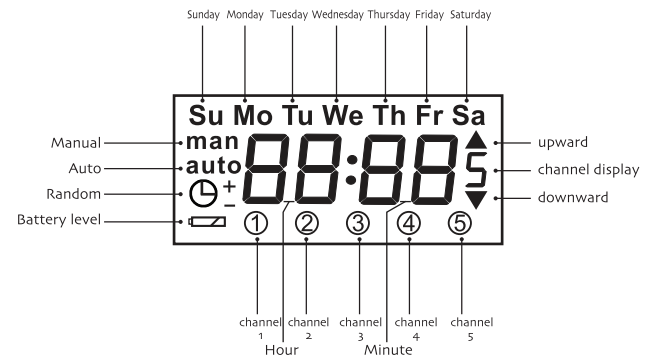

DC661 LCD Screen



Self-lock function

Additional Function

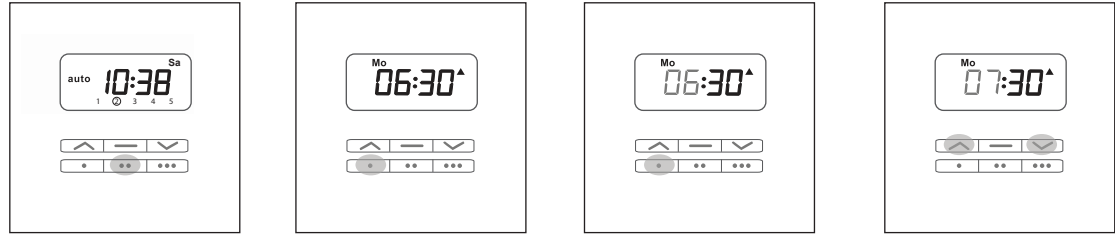

Press "setting button" for 2 seconds to switch to Auto mode or Random mode.

Press "channel decreasing button" for 5 seconds, the up timing time of channel 1 displays.

Press "channel decreasing button" again, the up timing time (hour mark) of channel 1 twinkles.

Press "up button" or "down button" to adjust the timing time (hour mark) of display screen.

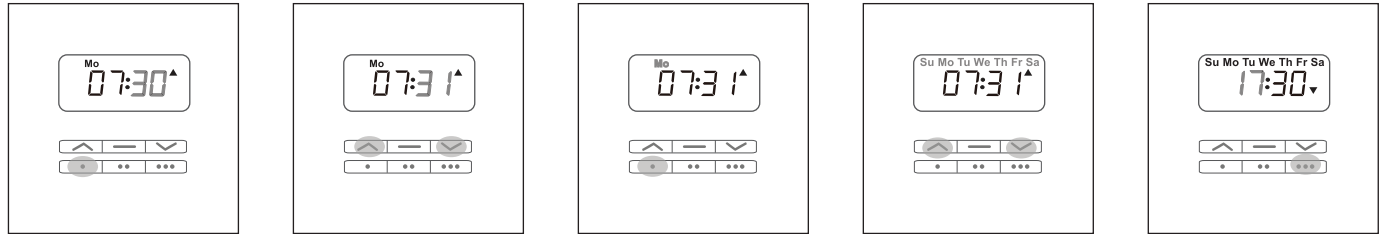

Press "channel decreasing button", the up timing time (minute mark) of this channel twinkles.

Press "up button" or "down button" to adjust the timing time (minute mark) of display screen.

Press "channel decreasing button", the up timing time (week mark) of this channel twinkles.

Press "up button" or "down button" to adjust the timing time (week mark) of display screen.

Press "channel increasing button" to confirm the up timing time of this channel. In the meantime the down timing time(hour mark) twinkles.

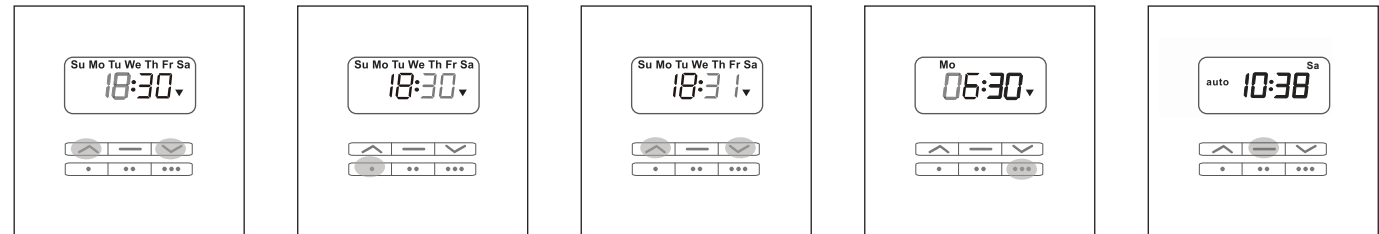

Press "up button" or "down button" to adjust the down timing time (hour mark) of display screen.

Press "channel decreasing button", the down timing time (minute mark) of this channel twinkles.

Press "up button" or "down button" to adjust the down timing time (minute mark) of display screen.

Press "channel increasing button" to confirm the down timing time of this channel. In the meantime the up timing time(hour mark) of the next channel twinkles.

Press "stop button", exit the adjustment of the timing time and back to present channel and present time.



Adding program when matching with R/E/ED motors

Additional Function

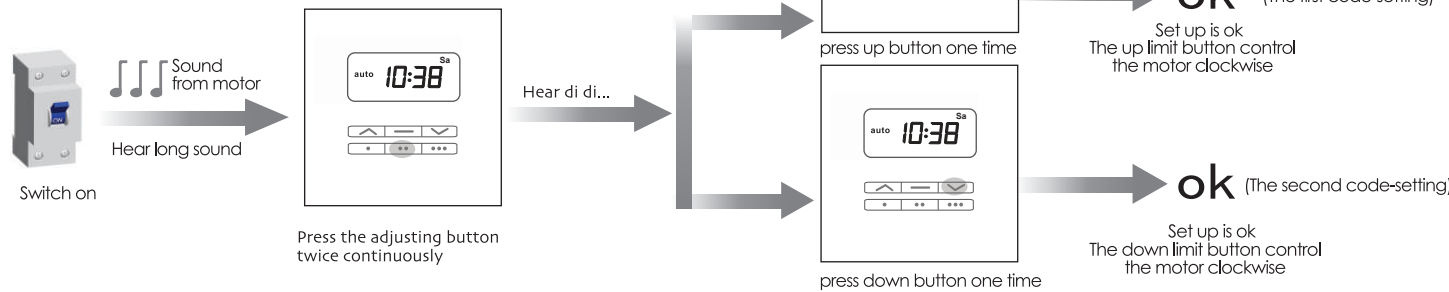

Adding program when matching with R/E/ED motors

Additional Function

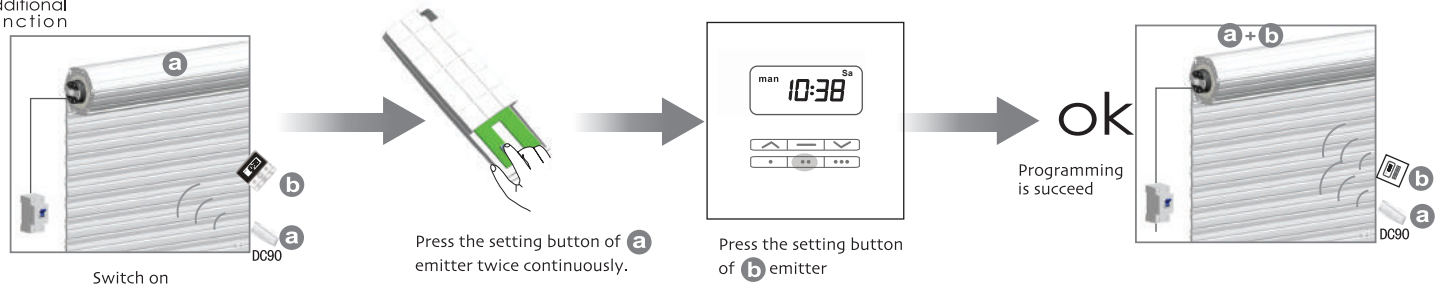

Programming and adding program when matching with DC41/DC42

Additional Function

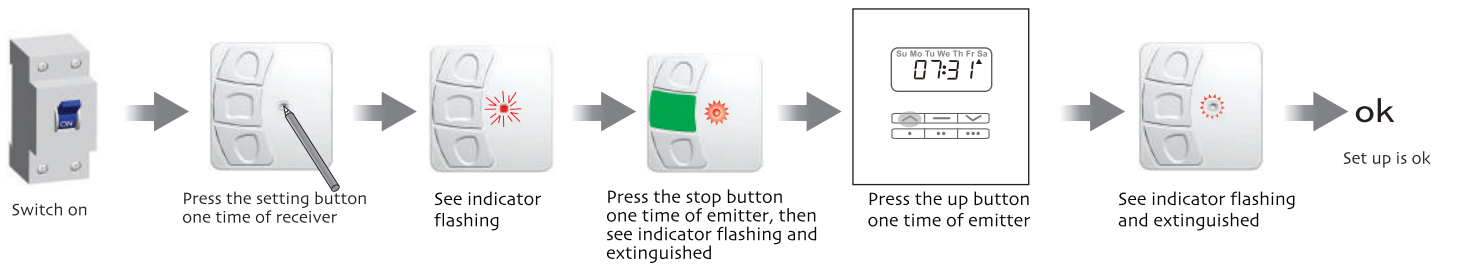

Programming and adding program when matching with DC43

Additional Function

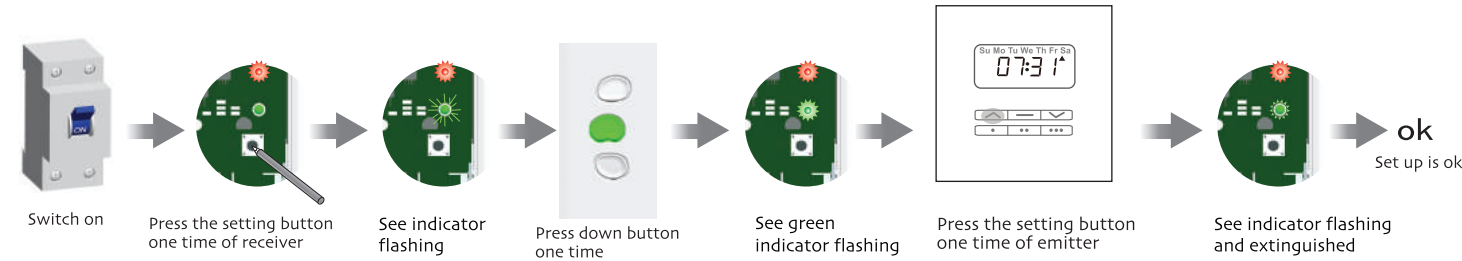

Programming and adding program when matching with DC136

Additional Function

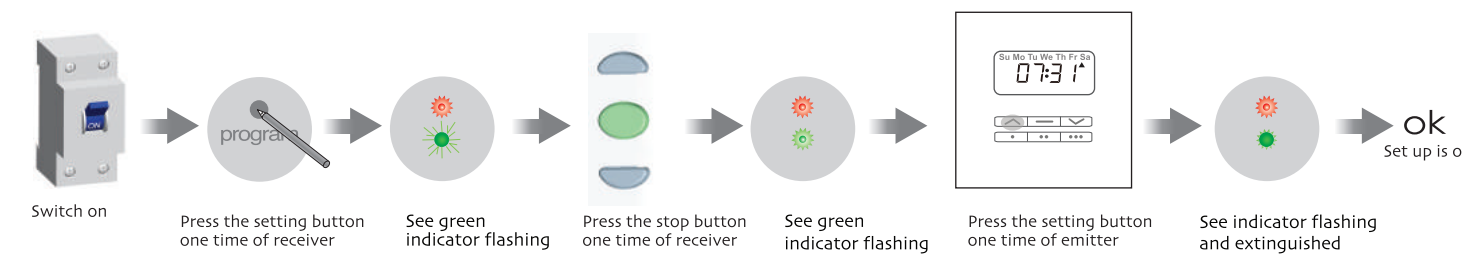

Each channel can set timer function separately



The interval of different button must within 10 seconds of all setting, otherwise the system will restore the original state



One receiver store 20 emitters channels at most, and one channel of emitter can control 20 receivers at most.



The interval of different button must within 10 seconds of all setting, otherwise the system will restore the original state



One receiver store 20 emitters channels at most, and one channel of emitter can control 20 receivers at most.



The interval of different button must within 10 seconds of all setting, otherwise the system will restore the original state



One receiver store 20 emitters channels at most, and one channel of emitter can control 20 receivers at most.



Delete all the datas of the motor and the new emitter has been programmed.



Set up is ok
The up limit button control the motor clockwise



Set up is ok
The down limit button control the motor clockwise