

# DC50

## Receiver Specification

Version NO. : A/00

**T**

Technical support

### Receiver specification



DC50 receiver

Maximum output power: 500W  
One DC50 receiver can store maximum 20 emitter channels. If there are already 20 channels, it will take turns to Cover the last channel.



- When emitter is under group control, match code will be invalid.
- When receiver is in dot-move mode, press up or down button within 2 seconds, motor will be controlled to operate in Dot-move mode; if keep pressing over 2 seconds, motor will continuously work.

**T**

Technical support

### Control range



Effective transmitting distance may have deviation due to actual environment

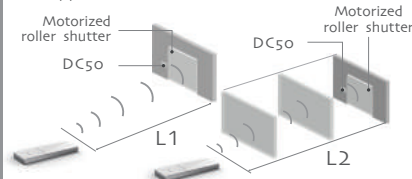

|           | L1 open | L2 partition | Emission frequency |
|-----------|---------|--------------|--------------------|
| 230V/50Hz | 200m    | 35m          | 433.92MHz          |
| 120V/60Hz | 200m    | 35m          | 868MHz             |

**T**

Technical support

### Matchable emitter



For the emitters without set button like DC316, you can press up button and stop button at the same time to work as the same function as set button.

**T**

Technical support

### Matchable motor



DM45S



DC50 receiver

**T**

Technical support

### Mode of connection



230V/50Hz or 120V/60Hz according to product nameplate

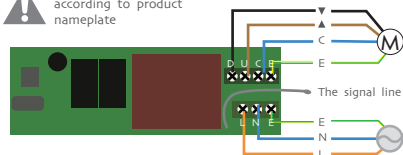

Black=Down  
Brown=Up  
Blue=Common  
Green/Yellow=Earth  
Blue=Neutral  
Green/Yellow=Earth  
Brown=Live

### The best installation distance



- The shortest distance between receiver and ground  $\geq 1.5m$
- The shortest distance between receiver and roof  $\geq 0.3m$
- The shortest distance between receiver and receiver  $\geq 0.2m$

**A**

Additional function

### Setting up

During the settings, the time between two operation must be shorter than 6s, otherwise it will quit the setting

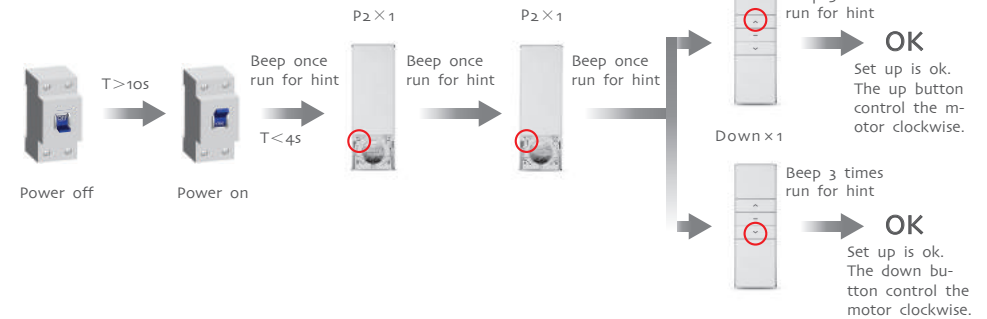
**A**

Additional function

### Add Emitter

During the settings, the time between two operation must be shorter than 6s, otherwise it will quit the setting

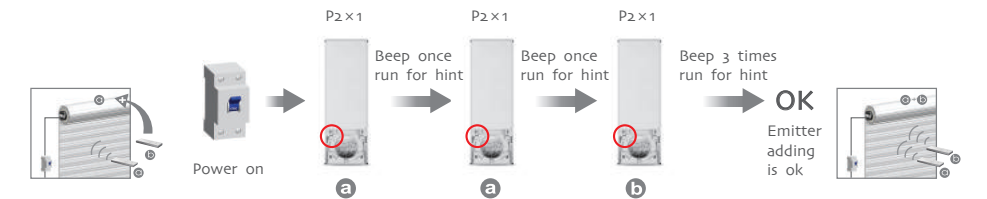
**A**

Additional function

### Light adjust function

During the settings, the time between two operation must be shorter than 6s, otherwise it will quit the setting

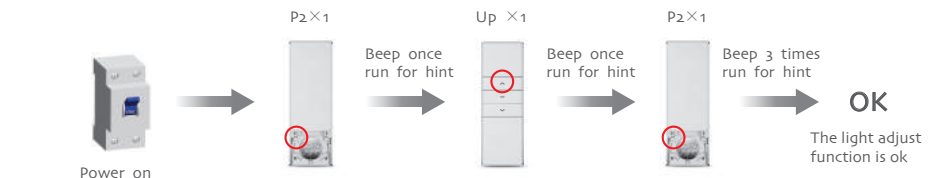

Repeat setting, function is cancelled

**A**

Additional function

### Cancel emitter

During the settings, the time between two operation must be shorter than 6s, otherwise it will quit the setting



Cancel emitter setting is to clear all the data in receiver

