



In order to fully explore available functions of SKIDA YSH pilot please take a moment and read this manual before using the device.



SKIDA YSH is dedicated to two-way communication.

1. General information



Single-channel SKIDA YSH key-ring remote control (SKIDA_1Rk YSH)

1. Control:
can control single motor,
or a group of up to 20 motors

2. Range:
150 meters outdoor,
35 meters indoor

3. Battery:
CR2032

4. Power supply:
3 V

5. Dimensions:
53 x 30 x 15 mm

6. Transmitting power:
10 mW

7. Operating temperature:
from -5°C to 50°C

8. Protection degree:
IP 44



Radio receiver range is a variable value and can differ from declared values depending on conditions in which device operates. Possible sources of changes in range are building construction, interference caused by other radio transmitters etc.

2. Detailed description

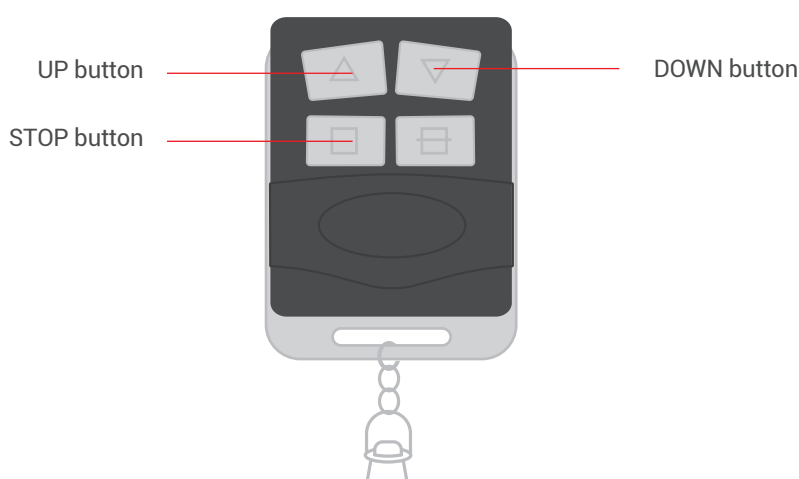

1. Batteries should be changed when LED diode stops flashing or receiving device stops reacting to commands.
2. When replacing the battery, pay attention to the correct polarity.



Batteries contain substances that may be hazardous to health and may pollute the environment. Used batteries should be disposed of properly.