

433 MHz



In order to fully explore available functions of PORTA series please take a moment and read this manual before using the device.
PORTA transmitters are compatible with all YOODA brand devices control.

1. General information



Single-channel PORTA key-ring remote control, (PORTA_1Rk)

1. Control:
can control single motor, or a group
of up to 20 motors

2. Range:
200 meters outdoor,
35 meters indoor

3. Battery:
27A

4. Power supply:
12 V

5. Dimensions:
55 x 38 x 13 mm

6. Transmitting power:
10 mW

7. Operating temperature:
from -10°C to 50°C

8. Protection degree:
IP 44



Radio receiver range is a variable value and can differ from declared values depending on conditions in which device operates. Possible sources of changes in range are building construction, interference caused by other radio transmitters etc.

2. Detailed description

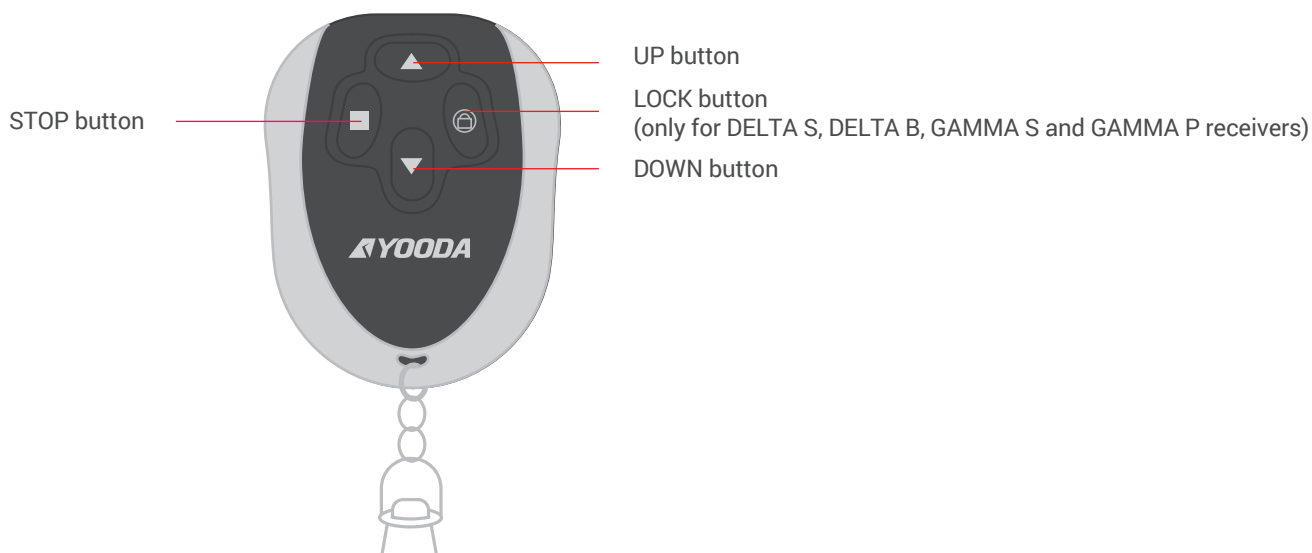

1. Estimated battery lifespan is 3 year if the device runs 4 commands a day in average.
2. Batteries should be changed when LED diode stops flashing or receiving device stops reacting to commands.
3. When replacing the battery, pay attention to the correct polarity.



Batteries contain substances that may be hazardous to health and may pollute the environment. Used batteries should be disposed of properly.

3. Programming first transmitter to R-type motors



1. Way of programming first transmitter depends on type of radio receiver. When programming first transmitter please follow instruction of the device that is going to be controlled by the transmitter.
2. Longer than 5 seconds pause between series of button clicks during programming will cause device to switch off from programming mode without saving any changes.
3. Programming transmitter using this method will result in deleting receiver memory.
4. Simultaneously pressing the STOP and UP buttons performs the function of programming button.

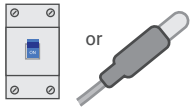

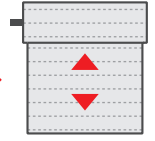
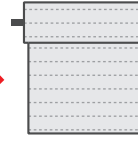
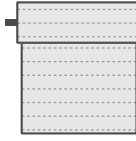
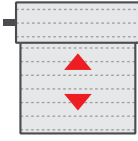

or



Turn on power supply or press microswitch (for 2 sec.) when power is on.

Motor will make a sound. Roller shutter will make an up/down move.

Press simultaneously STOP  and UP  buttons.

Motor will make a sound.

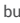
Press simultaneously STOP  and UP  buttons.

Motor will make a sound.

Press UP button.

Roller shutter will make an up/down move and the motor will make a few short sounds.