



Non-compliance with the specification might cause risk for life or health and can determine proper work of the blinds.
We strongly recommend to comply with the specification.

1. General information



Motor for interior blinds with a chain system

1. Frequency of work:
433,92 MHz
2. Power supply:
battery 12 V
3. Power consumption:
1,2 A
4. Speed:
50 RPM/min.
5. Maximum dimensions of the blind:
2,5 x 2,5 m
6. Maximum weight of the blind:
10 kg
7. Memory:
9 transmitters
8. Torque:
1,35 Nm

power switch

charging socket

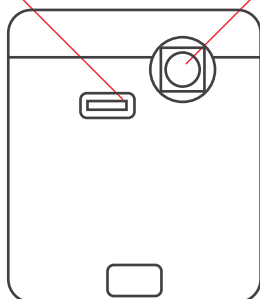

motor view
from below

programming button

UP button

STOP button

DOWN button

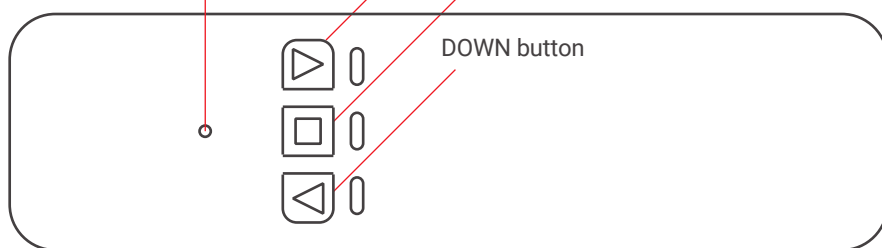

motor
front view

3 replaceable drive wheels
selected for the type of chain

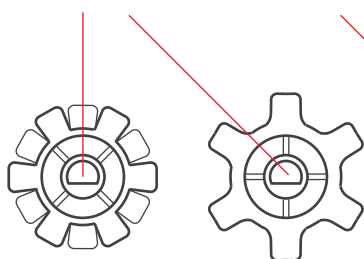

handle mounted to the motor

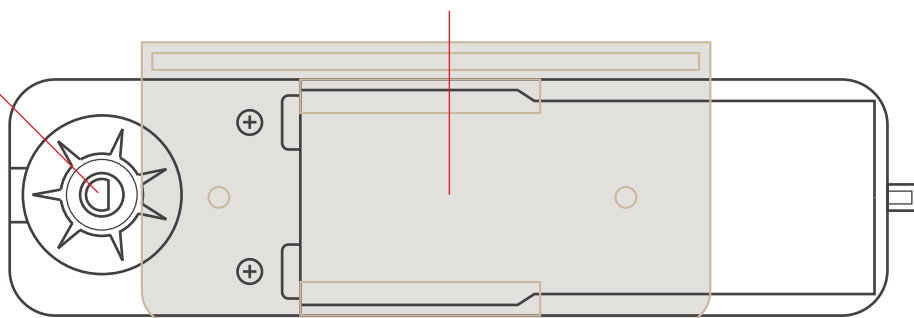

motor back view

2. Montage

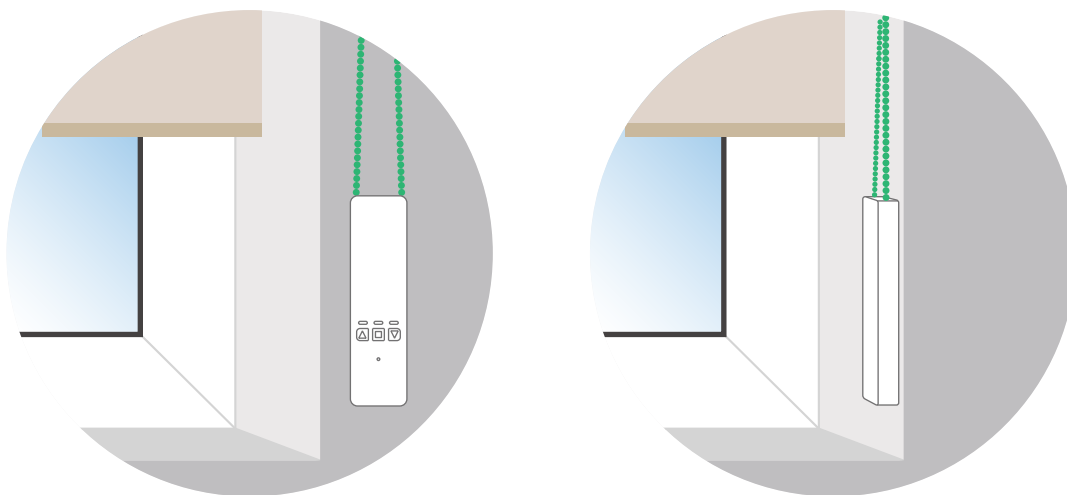

1. We mount the handle at the appropriate height, so the chain of the blind is stretched. The motor can be mounted in one of the two above positions.

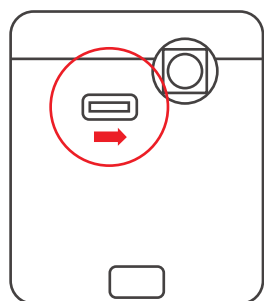

2. Turn on the motor power by moving the switch located on the bottom of the drive.

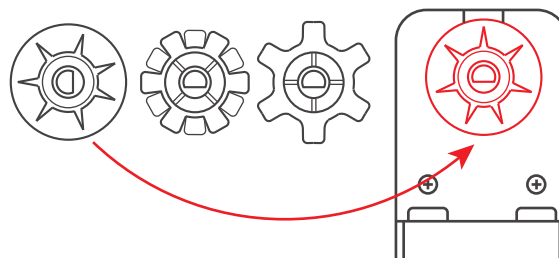

3. We adjust the appropriate drive wheel to the chain type of the blind. At the back of the motor open the cover and mount the wheel.

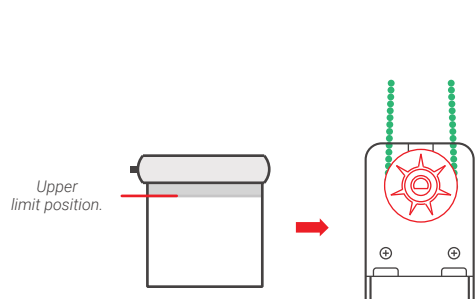

4. Set the blind in the upper limit position and put on a chain on the wheel.

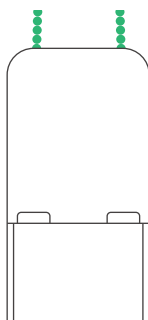

5. Close the cover.

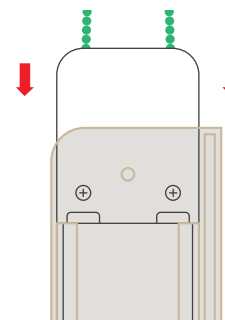

6. Insert the motor into the holder, and then sliding the motor down to tighten the chain of the blind.

3. Changing motor direction



Change the work direction of the motor when the blinds closes by using UP button.

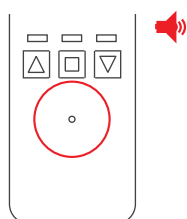

Press programming button.
Motor will make few short sounds.

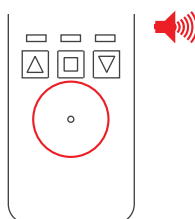

Press programming button again.
Motor will make one long sound.

Work motor direction
has been changed.

4. Programming the transmitter



We can programmed 9 transmitters to the motor.

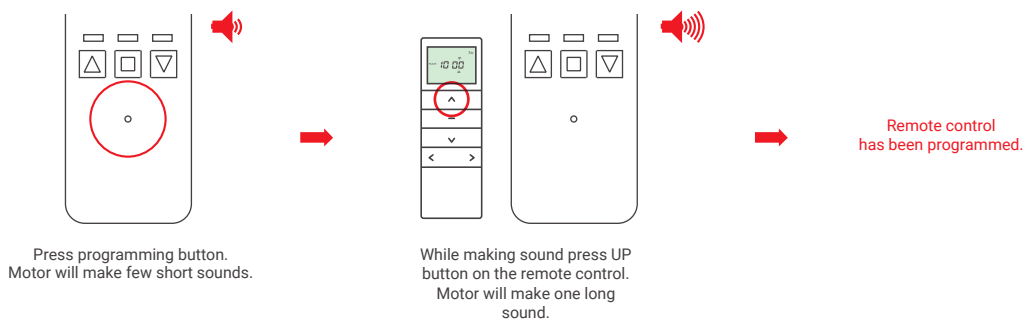

5. Deleting transmitters



The following procedure will delete programmed transmitters for the motor.

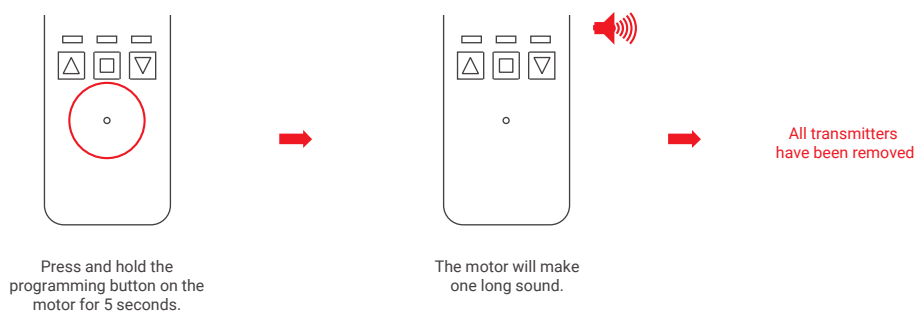

6. Programming limit positions

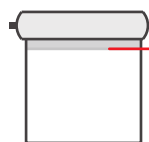

An example
of the upper limit
position of the blind.

Adjust the blind in the upper
or lower limit position.

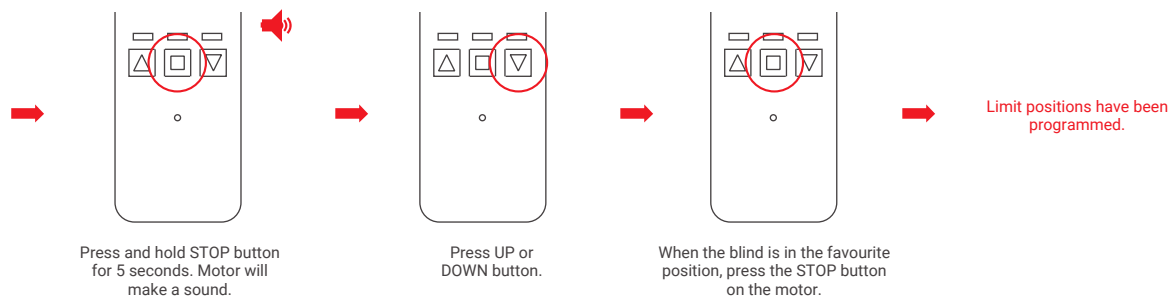

7. Programming the third limit position

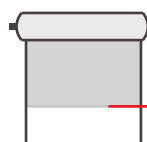

An example
of the third
limit position

Set the blind in
the third limit position.

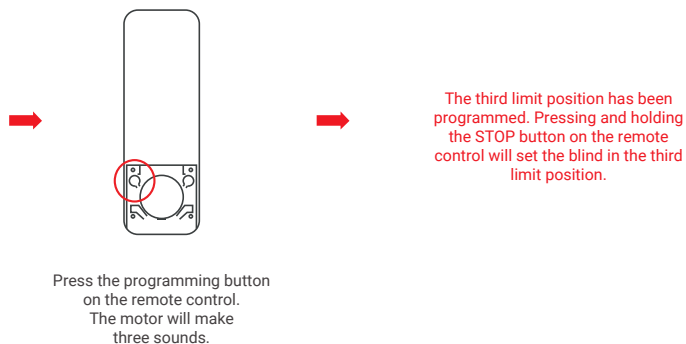

6. Charging the motor

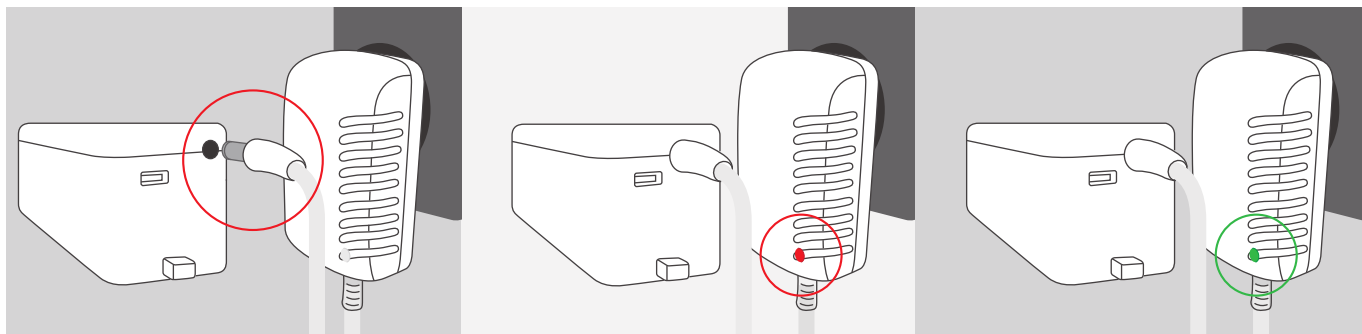

We connect the charger to the motor.

During charging, the LED diode lights red.

When the battery is charged, the LED diode is green.

7. Disassembly of the motor

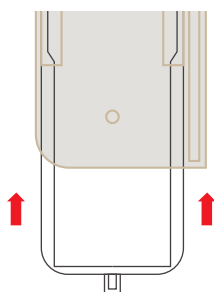

To remove the motor from the holder, press the button at the bottom of the motor and move it up.

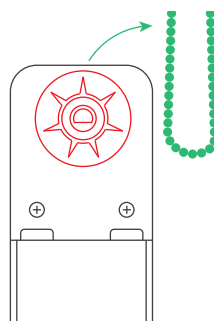

Open the drive wheel cover and remove the roller chain.



The motor has been disassembled.