

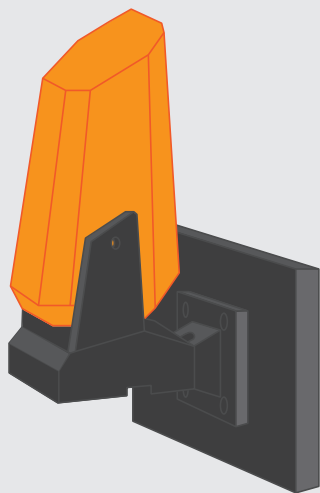

In order to fully explore available functions of signal lamp series please take a moment and read this manual before using the device. Signal lamps are compatible with all TENPILOT brand devices.

## 1. General information



1. Power supply:  
24V DC/AC or 80V-250V AC
2. Frequency of antenna operation:  
433.92 MHz
3. Operating temperature:  
from -20° C to 45° C
4. Protection degree:  
IP 64
5. Dimensions:  
95 x 60 x 170 mm

## 2. Montage

### 2.1 Installation on a horizontal plane

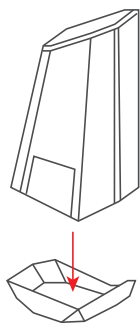

Connect the transparent upper housing with the bottom part.

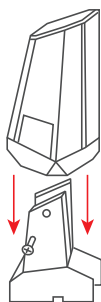

Connect the lamp housing with the handle by using the screws.

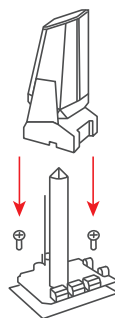

Attach the base of the lamp to a horizontal plane. Connect the lamp housing with the base.

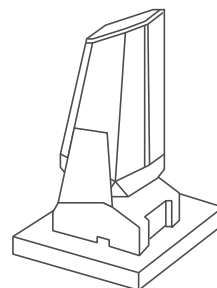

The lamp has been mounted correctly.

### 2.2 Installation on the vertical plane.

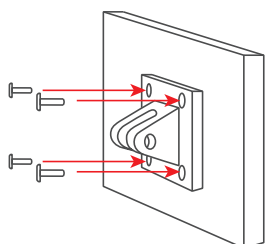

Przymocuj wspornik ścienny lampy do płaszczyzny pionowej.

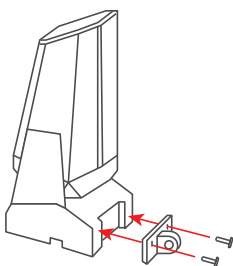

Screw the lamp connector.

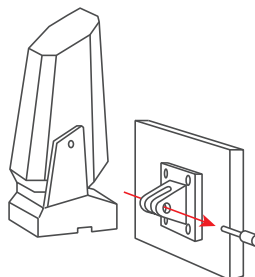

Connect the lamp to the wall bracket using a stem.

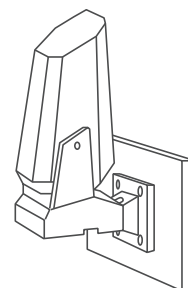

The lamp has been mounted correctly.

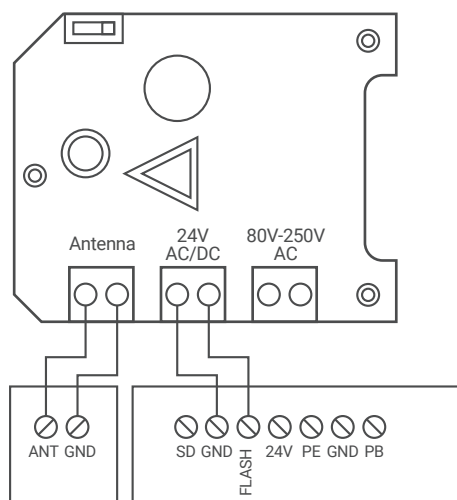

drive connectors

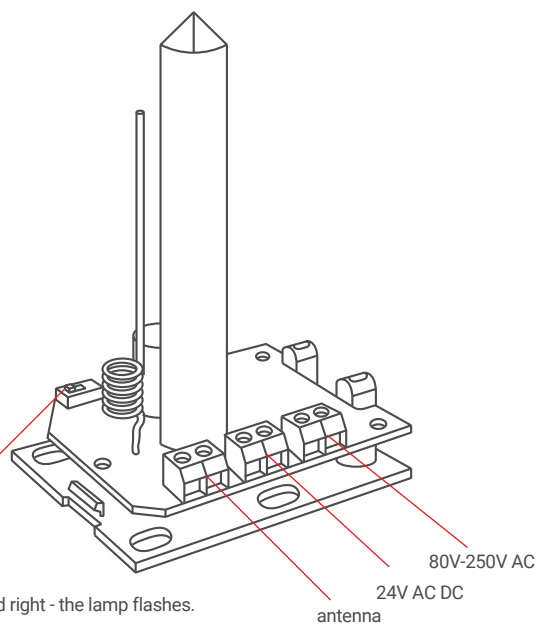

a) Toggle switch moved right - the lamp flashes.

b) Toggle switch moved left - the lamp is permanently on, control from the drive panel.