



In order to fully explore available functions of MAGNETIC DELUXE YSH series please take a moment and read this manual before using the device. MAGNETIC DELUXE YSH transmitters are compatible with all YOODA SMART HOME brand devices.



MAGNETIC Deluxe YSH transmitters are dedicated to two-way communication.

1. General information



15-channel MAGNETIC DELUXE YSH remote control, white (MAGNETIC Deluxe_15R YSH)

1. Control:
can control single motor, or a group of up to 20 motors on each channel

2. Range:
200 meters outdoor,
35 meters indoor

3. Battery:
CR2450

4. Power supply:
3 V

5. Dimensions:
130 x 45 x 10 mm

6. Transmitting power:
10 mW

7. Operating temperature:
from 0°C to 50°C

8. Protection degree:
IP 30



Radio receiver range is a variable value and can differ from declared values depending on conditions in which device operates. Possible sources of changes in range are building construction, interference caused by other radio transmitters etc.

2. Detailed description

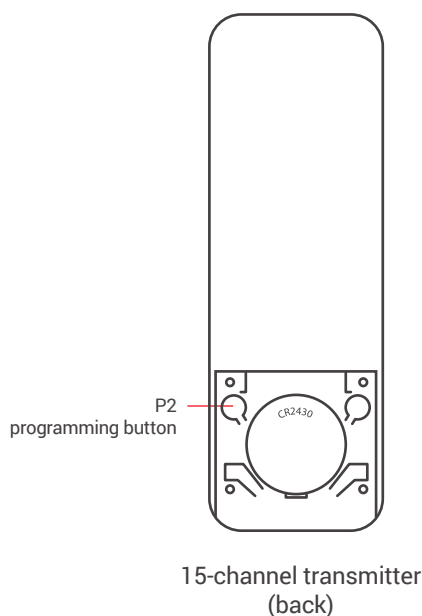
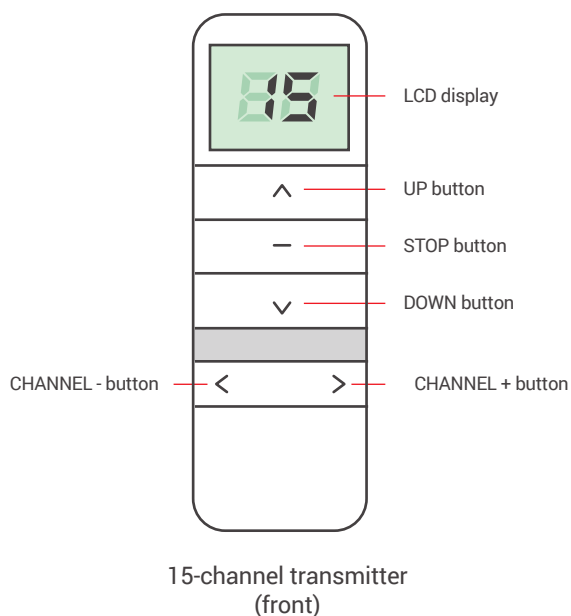

1. Estimated battery lifespan is 1 year if the device runs 4 commands a day in average.
2. Batteries should be changed when receiving device stops reacting to commands.
3. When replacing the battery, pay attention to the correct polarity.



Batteries contain substances that may be hazardous to health and may pollute the environment. Used batteries should be disposed of properly.

3. Active channel selection



Pressing UP or DOWN button exits active channel selection mode. Repeat the following procedure to set the number of active channels.

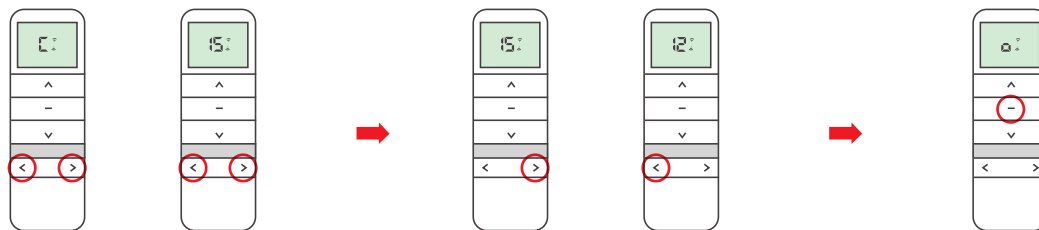

Press simultaneously and hold down the CHANNEL+ and CHANNEL- buttons. "C" symbol appears on the display and then after 4 seconds it changes to number 15 with up and down arrows.

Use the CHANNEL+ or CHANNEL- buttons to set the number of displayed channels.

Press the STOP key to confirm your choice. The symbol "0" should appear.

4. Function buttons lock



1. The function buttons lock prevents accidental operation of two buttons used when programming motors or radio receivers.
2. This function is factory disabled. To on / off the function, follow the procedure below.



When "L" symbol will appear on the display the function is on.

When "U" symbol will appear on the display the function is off.

Press and hold STOP button for about 15 seconds.

5. Selection of the transmitter's operating mode.



1. The transmitter can operate in one of two modes:
 - a) two-way
 - b) one-way
2. The transmitter factory operates in two-way mode.

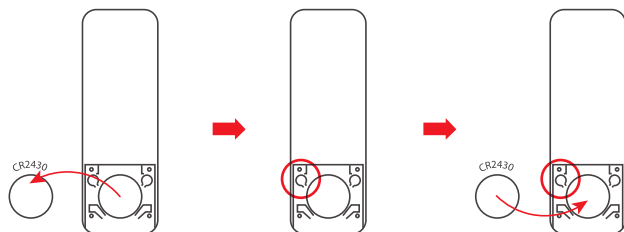

Remove the battery from the transmitter.

Press programming button P2.

When holding the P2 programming button, insert the battery.

When "1" number will appear on the display transmitter is on two-way mode.

When "2" number will appear on the display transmitter is on one-way mode.

6. Programming first transmitter to EV/S-type motors



1. Way of programming first transmitter depends on type of radio receiver. When programming first transmitter please follow instruction of the device that is going to be controlled by the transmitter.
2. Longer than 6 seconds pause between series of button clicks during programming will cause device to switch off from programming mode without saving any changes.
3. If the end positions aren't set, the programming of the first transmitter will delete all existing transmitters from memory.
4. Choosing '0' group channel means remote controls all programmed devices on all channels at the same time. No programming functions can be performed on group channel. All devices programmed to any other channel can be controlled on group channel without additional programming.

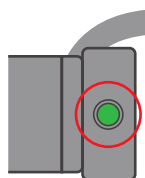

Turn on power supply or press programming button on motors head (for 2 sec.) when power is on.

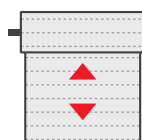

Motor will make a sound. Roller shutter will make an up/down move.

2



Press STOP button for a 2 seconds on the remote.

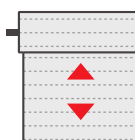

Roller shutter will make an up/down move and the motor will make a few short sounds.