

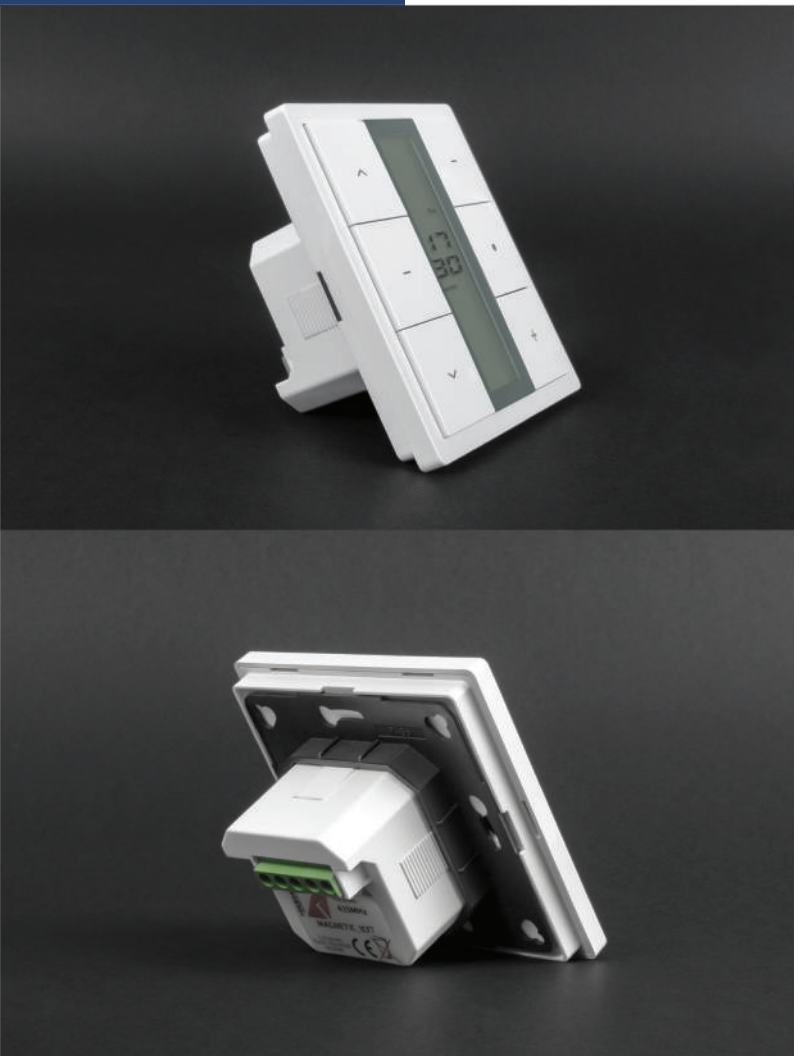

In order to fully explore available functions of MAGNETIC series please take a moment and read this manual before using the device. MAGNETIC transmitters are compatible with all YOODA brand devices.

General information



1. Control:  
can control single motor
2. Memory:  
up to 20 transmitters
3. Range:  
200 meters outdoor,  
35 meters indoor
4. Power supply:  
230 V / 50 Hz
5. Output voltage:  
230 V / 50 Hz
6. Output power:  
300 W
7. Dimensions:  
80 x 80 x 43 mm
8. Operating temperature:  
from 0°C to 50°C
9. Protection degree:  
IP 30
10. Time of settings being saved  
in case of power shortage:  
up to 4 hours

Illustrations (from the top):  
Fig. 1. Single-channel CAMELEO control unit, white, front  
Fig. 2. Single-channel CAMELEO control unit, white, back



Radio receiver range is a variable value and can differ from declared values depending on conditions in which device operates. Possible sources of changes in range are building construction, interference caused by other radio transmitters etc.

Detailed description

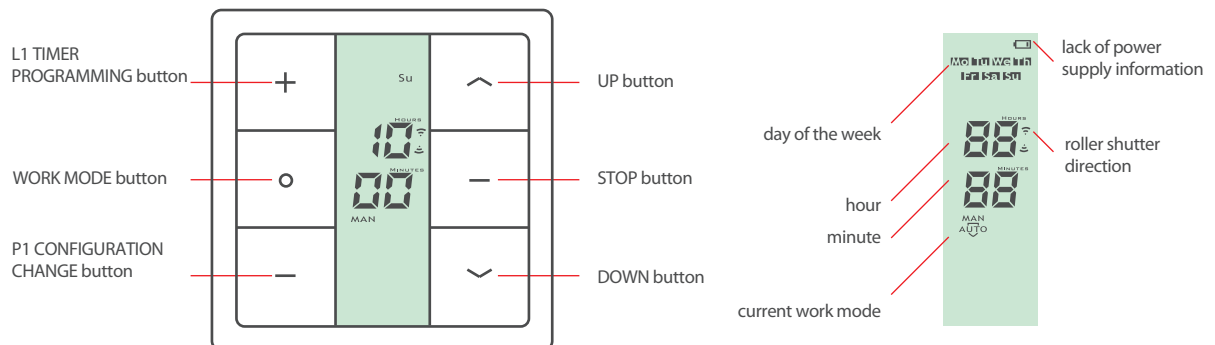

433 MHz



In order to fully explore available functions of MAGNETIC series please take a moment and read this manual before using the device. MAGNETIC transmitters are compatible with all YOODA brand devices.

## Connection



Optimal mounting parameters:

1. Minimal length from the ground > 1,5 m,
2. Minimal length from the wall and ceiling > 0,3 m,
3. Minimal length from the receiver > 0,2 m.

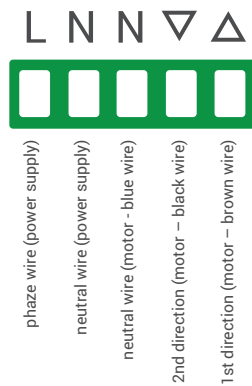

power supply:  
230 V / 50 Hz

motor:  
230 V / 50 Hz



Installation of the tubular motor should be performed by specialists with 1kV or higher SEP-certified electrician's licence (SEP - Association of Polish Electrical Engineers) or equal license. Device is designed to operate in places shielded from unfavourable weather conditions. Motor should be installed in accordance with all provisions of regional law and professional standards. All cables connecting power receiver with electric source should be protected from overload and short-circuits effects with devices automatically disconnecting power. Device should be powered with a separate source and protected only with a fast-blow fuse (never slow-blow fuse). Creating electrical system using inadequate fuse may result in losing rights under the provisions of warranty. When connecting device to power source with cables with adequate cross-section should be used. Long-lasting output load capacity table should be the ground for choosing adequate cables.

## Changing work mode



1. Manual work mode (Displays MAN symbol: standard mode without using time programming function).
2. Automatic mode (displays AUTO symbol): standard mode with activated automatic work time.
3. Random work mode (displays  $\Delta \nabla \circ$  symbol): automatic mode with random time of work (15 minutes difference from programmed time).

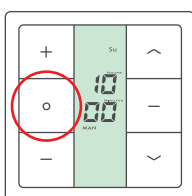

By pressing WORK MODE button for about 3 seconds work mode will change to manual mode.

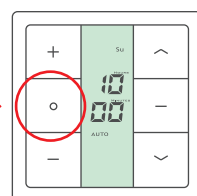

By pressing WORK MODE button for about 3 seconds work mode will change to automatic mode.

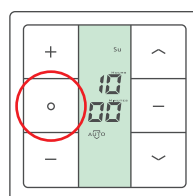

By pressing WORK MODE button for about 3 seconds work mode will change to random mode.

Pressing WORK MODE button will cause for work mode to change again.

433 MHz



In order to fully explore available functions of MAGNETIC series please take a moment and read this manual before using the device. MAGNETIC transmitters are compatible with all YOODA brand devices.

## Setting current time



Time can be set only when device is in manual working mode. Longer than 60 seconds pause between series of button clicks during programming will cause device to switch off from time setting mode without saving any changes.

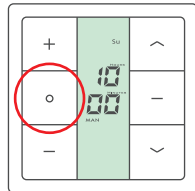

By pressing WORK MODE button choose manual work mode.

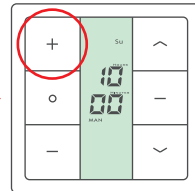

Press and hold L1 TIMER PROGRAMMING button for about 3 seconds (hour starts to flash).

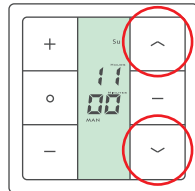

Using UP / DOWN buttons set hour.

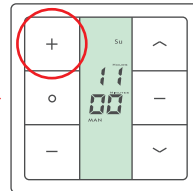

By pressing L1 TIMER PROGRAMMING button switch to minute setting (minute starts to flash).

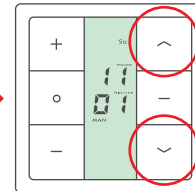

Using UP / DOWN buttons set minute.

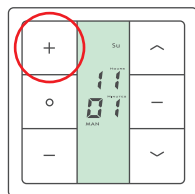

By pressing L1 TIMER PROGRAMMING button switch to day setting (day starts to flash).

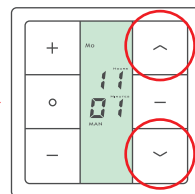

Using UP / DOWN buttons set current day of the week.

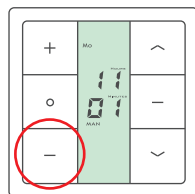

By pressing P1 CONFIGURATION CHANGE button for about 3 seconds confirm new setting.

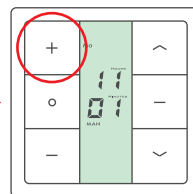

Pressing L1 TIMER PROGRAMMING button will start the clock.

## Changing automatic opening and closing time



1. Difference between automatic time of roller shutter opening and closing cannot be shorter than 32 minutes. In case of smaller than minimal time difference fault message will appear.
2. Changes to opening and closing time can be done only in automatic mode.
3. Longer than 60 seconds pause between series of button clicks during programming will cause device to switch off from time setting mode without saving any changes.
4. If while setting time of automatic opening or closing '---' symbol appears, it means that this time is not active in automatic mode.
5. To leave time programming mode without saving any changes press STOP button.

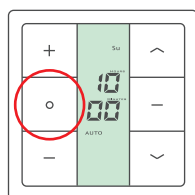

By pressing WORK MODE button choose random work mode.

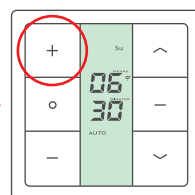

Press L1 TIMER PROGRAMMING button for 3 seconds. Current opening time will be displayed.

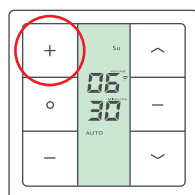

Press L1 TIMER PROGRAMMING button single time (hour of opening flashes).

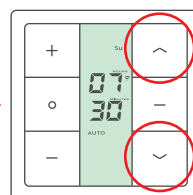

Using UP / DOWN buttons set hour.

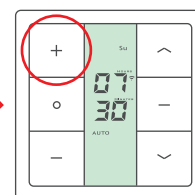

By pressing L1 TIMER PROGRAMMING button switch to minute setting (minute starts to flash).

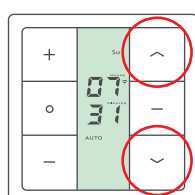

Using UP / DOWN buttons set minute.

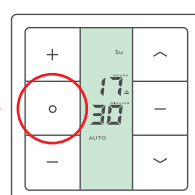

By pressing WORK MODE button switch to setting closing time.

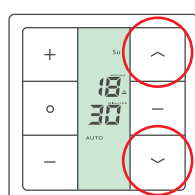

Using UP / DOWN buttons set hour.

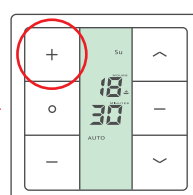

By pressing L1 TIMER PROGRAMMING button switch to minute setting (minute starts to flash).

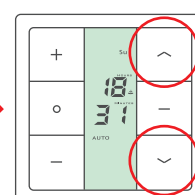

Using UP / DOWN buttons set minute.



In order to fully explore available functions of MAGNETIC series please take a moment and read this manual before using the device. MAGNETIC transmitters are compatible with all YOODA brand devices.

## Changing automatic opening and closing time

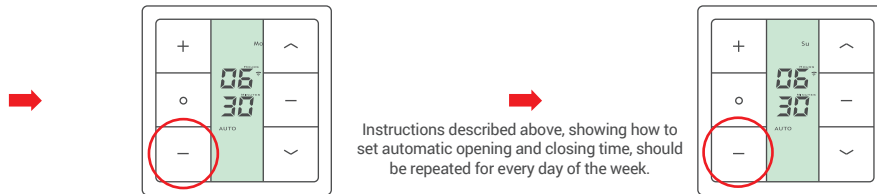

By pressing P1 CONFIGURATION CHANGE button confirm new setting. Control unit automatically switches to setting time of automatic opening and closing for next day of the week.

Instructions described above, showing how to set automatic opening and closing time, should be repeated for every day of the week.

After setting automatic opening and closing time for every day of the week press and hold P1 CONFIGURATION CHANGE button for about 3 seconds to confirm all changes (current time starts to flash).

## Programming transmitters



1. Longer than 6 seconds pause between series of button clicks during programming will cause device to switch off from programming mode without saving any changes.
2. Procedure described below is to be used for programming first and all other transmitters. Receiver can hold in its memory up to 20 different transmitters. Programming another transmitter will cause for the first transmitter on the list of 20 already programmed to be deleted.

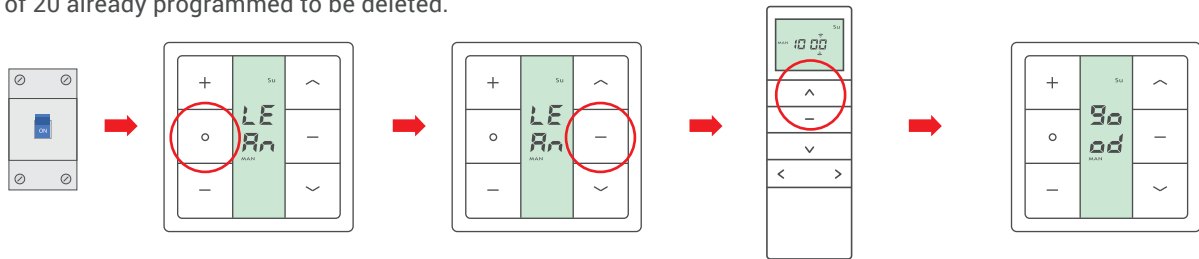

Switch power on.

Press and hold WORK MODE button for about 6 seconds ('LEAr' sign start to flash).

Press STOP button ('LEAr' sign stops to flash).

Press STOP button on transmitter that is being programmed.

'good' sign will flash three times confirming, that new transmitter was successfully programmed.

## Deleting transmitter



Longer than 6 seconds pause between series of button clicks during programming will cause device to switch off from deleting mode without saving any changes.

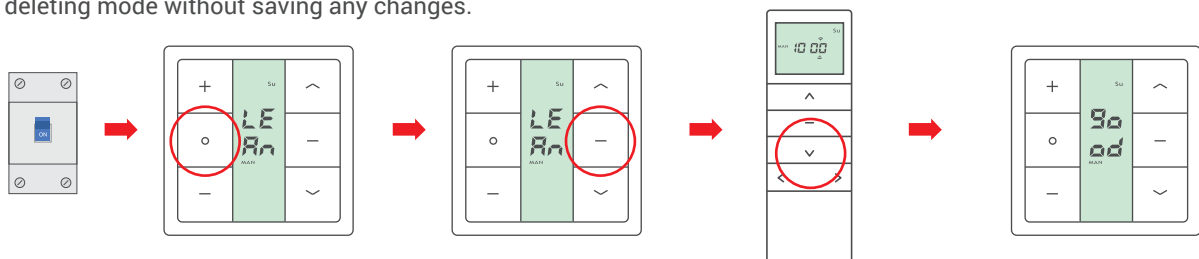

Switch power on.

Press and hold WORK MODE button for about 6 seconds ('LEAr' sign starts to flash).

Press STOP button ('LEAr' sign stops to flash).

Press DOWN button on transmitter that is being deleted.

'good' sign will flash three times confirming, that new transmitter was successfully deleted.

## Deleting all transmitters



Proceeding with this instruction will cause for all transmitters to be deleted from receivers memory.

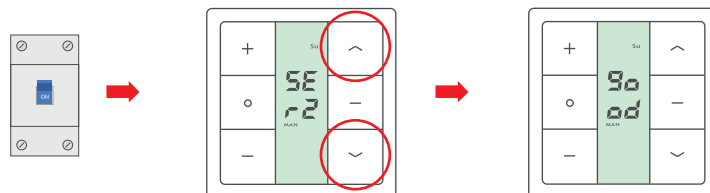

Switch power on.

Press and hold STOP / DOWN buttons at the same time for about 6 seconds ('SET2' sign starts to flash).

'good' sign will flash three times confirming, that all programmed transmitter were successfully deleted.

433 MHz



In order to fully explore available functions of MAGNETIC series please take a moment and read this manual before using the device. MAGNETIC transmitters are compatible with all YOODA brand devices.

## Activating impulse mode



When impulse mode is activated, single push of UP or DOWN button forces motor to make single part of a full turn, and when UP or DOWN button is being held for 2 seconds it will force motor to run constantly (to the point it reaches its limit position).

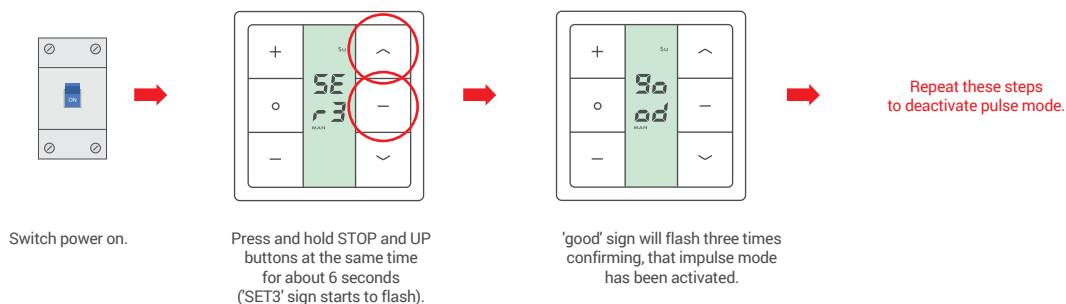

## Changing motors direction



Procedure should be performed when motor works in direction other than expected (e.g. when pressing UP button roller shutter is being lowered).

