



In order to fully explore available functions of MAGNETIC series please take a moment and read this manual before using the device. MAGNETIC transmitters are compatible with all YOODA brand devices.

1. General information



1. Control:
can control single motor, or a group
of up to 20 motors on each channel

2. Range:
200 meters outdoor,
35 meters indoor

3. Battery:
CR2430

4. Power supply:
3 V

5. Dimensions:
80 x 80 x 14 mm

6. Transmitting power:
10 mW

7. Operating temperature:
0°C + 50°C

8. Protection degree:
IP 30

15-channel MAGNETIC wall-mounted remote control, white (MAGNETIC_15Rw)



Radio receiver range is a variable value and can differ from declared values depending on conditions in which device operates. Possible sources of changes in range are building construction, interference caused by other radio transmitters etc.

2. Detailed description

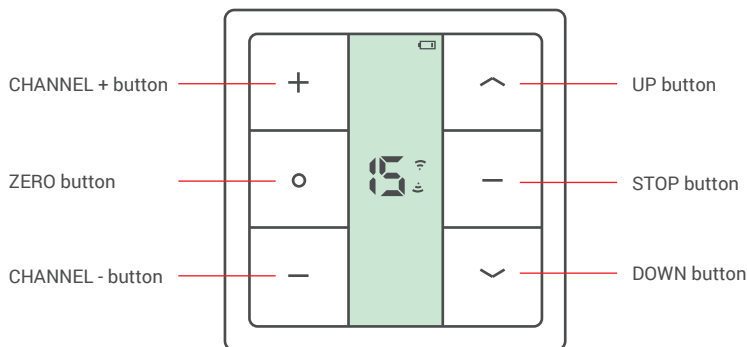

15-channel transmitter
(front)

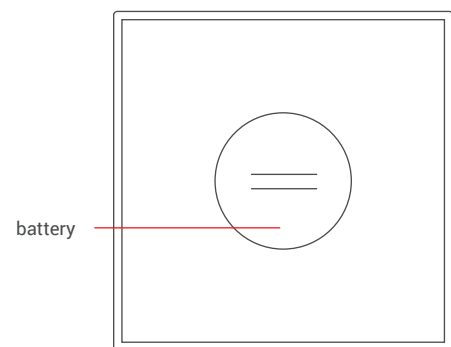

15-channel transmitter
(back)



1. Pushing simultaneously ZERO and CHANNEL+ - has the function of P2 programming button
2. When you press the ZERO button, the digit 0 will appear, which indicate the group channel. On this channel, all the devices programmed for each channel of the transmitter are active. On the group channel we do not perform any programming procedures.
3. Estimated battery lifespan is 3 year if the device runs 4 commends a day in average.
4. Batteries should be changed when no channel number is displayed after pressing any button or receiving device stops reacting to commands.



5. Batteries contain substances that may be hazardous to health and may pollute the environment. Used batteries should be disposed of properly.

3. Active channel selection



Pressing UP or DOWN button exits active channel selection mode. Repeat the following procedure to set the number of active channels.

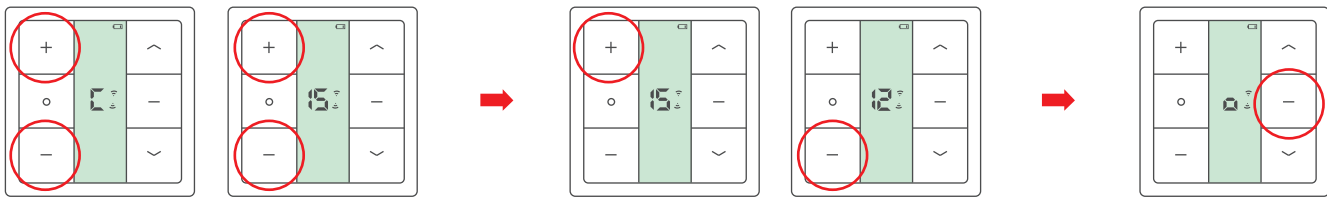

Press simultaneously and hold down the CHANNEL + and CHANNEL- buttons. "C" symbol appears on the display and than after 4 seconds it changes to number 15 with up and down arrows.

Use the CHANNEL + or CHANNEL -buttons to set the number of displayed channels.

Press the STOP key to confirm your choice. The symbol "o" should appear.

4. Programming first transmitter to R-type motors



1. Way of programming first transmitter depends on type of radio receiver. When programming first transmitter please follow instruction of the device that is going to be controlled by the transmitter.
2. Longer than 5 seconds pause between series of button clicks during programming will cause device to switch off from programming mode without saving any changes.
3. Programming transmitter using this ethod will result in deleting receiver memory.

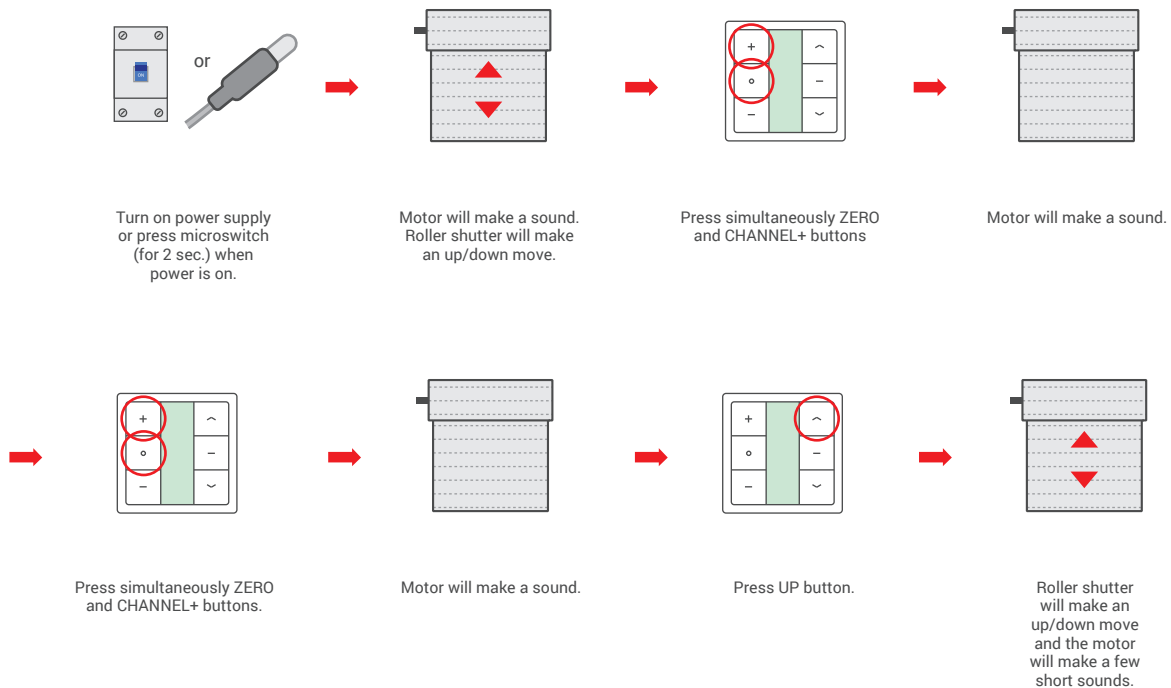

Turn on power supply or press microswitch (for 2 sec.) when power is on.

Motor will make a sound. Roller shutter will make an up/down move.

Press simultaneously ZERO and CHANNEL+ buttons

Motor will make a sound.

Press simultaneously ZERO and CHANNEL+ buttons.

Motor will make a sound.

Press UP button.

Roller shutter will make an up/down move and the motor will make a few short sounds.